

Recommended P.C. Board Layout
SCALE 6:1

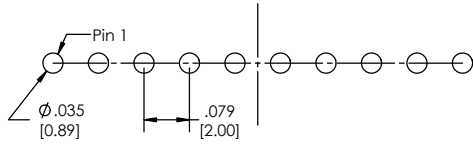

SINGLE ROW

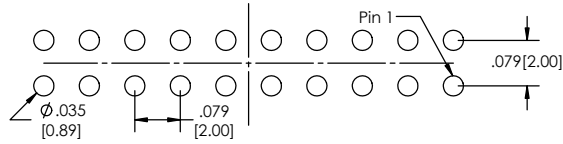

DOUBLE ROW

SINGLE ROW

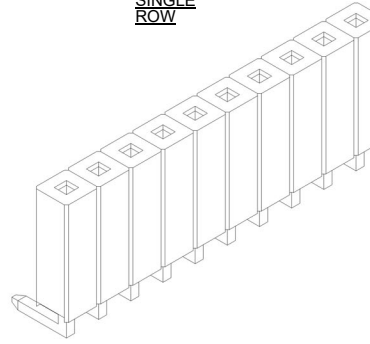

DOUBLE ROW

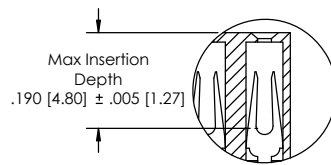
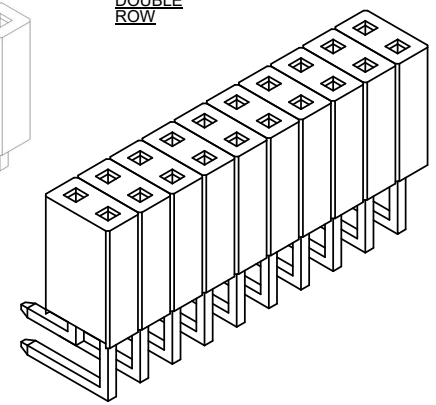

APPLICATION

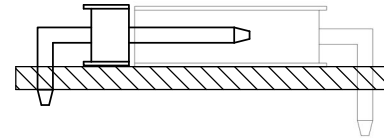

SINGLE ROW

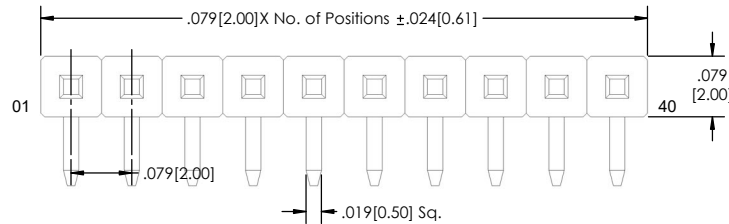
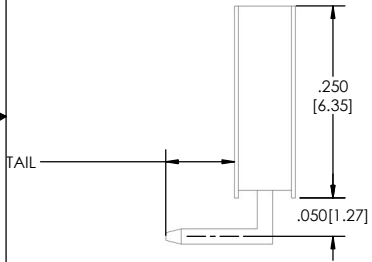

DOUBLE ROW

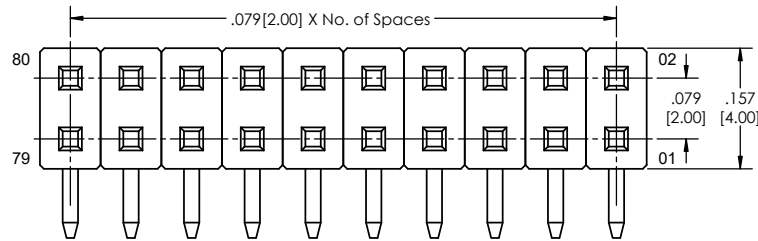
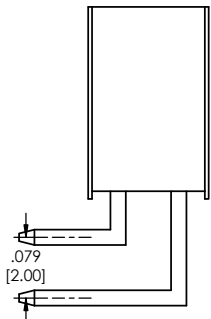

SSHQR-2 **(A)** **(B)** **(C)** **(D)** **(E)** **(F)** **(G)**

- A. Pins Per Row
- 1 through 40
- B. Row Specification
- S= Single Row
- D= Double Row
- C. Pin Options
- See Pin Options below
- D. Plating Options
- See Plating Options below
- E. Lock Tight "LT" (Optional)
- Leave blank if not needed
- LT= With
- F. Polarized Position
- Leave blank if not needed
- If required, specify empty pin position
- e.g. 012 for Pin 12
- G. Lead Free

Mates with:

BSTC	TSHR
BSTCM	TSHRE
BSTCR	TSHS
BSTCRSM	TSHRE
BSTS	TSHS
TBSTC	TSHSCM
TBSTCM	TTSHC
TBSTS	TTSHCR
TSHC	TTSHCRE
TSHCR	TTSHR
TSHCRE	TTSHRE
TSHCRSM	TTSHS
TTSHSM	

Plating options	
G	-10µ Gold on Contact Area/ Flash on Tail
T	-Matte Tin all Over
GT	-10µ Gold on Contact Area/ Matte Tin on Tail
H	-30µ Gold on Contact Area/ Matte Tin on Tail
F	-Gold Flash over Entire Pin
FT	- Gold Flash on Contact Area/ Matte Tin on Tail

Specifications:

Insertion Force- Single Contact only- H Plating
4oz. [1.11N] avg with .079[2.00mm] sq. pin

Withdrawal Force- Single Contact only- H Plating:
3oz. [0.83N] avg with .079[2.00mm] sq. pin

Current Rating: 2.0 Ampere

Insulation Resistance: 1000M Ohms Min.

Dielectric Withstanding: 500V AC

Contact Resistance: 10M Ohms Max.

Operation Temperature: -40°C to +105°C

Max. Process Temperature
Peak: 260°C up to 10 secs.
Process: 230°C up to 60 secs.
Wave: 260°C up to 6 secs.
Manual Solder: 350°C up to 5 secs.

Pin Options	
Tail	
.090[2.29mm]	02
.248[6.30mm]	04
.406[10.31mm]	06

Materials:

Contact Material: Phosphor Bronze
Insulator Material: Nylon 6T
Plating: Au or Sn over 50µ" (1.27) Ni

Tails may be clipped to achieve specific dimensions.

Products cut to specific sizes are uncancellable/ nonreturnable.
Parts are subject to change without notice.



PROPRIETARY AND CONFIDENTIAL
THE INFORMATION CONTAINED IN THIS DRAWING IS THE SOLE PROPERTY OF Major League Electronics. ANY REPRODUCTION IN PART OR AS A WHOLE WITHOUT THE WRITTEN PERMISSION OF Major League Electronics IS PROHIBITED.

UNLESS OTHERWISE SPECIFIED:		NAME	DATE
DIMENSIONS ARE IN INCHES		DRAWN	EOW 01/21/15
TOLERANCES:		CHECKED	GWE 01/21/15
ONE DECIMALS ±.100		ENG APPR.	
TWO DECIMALS ±.005		MFG APPR.	
THREE DECIMALS ±.002		INTERPRET GEOMETRIC TOLERANCING PER:	
FOUR DECIMAL ±.002		MATERIAL	
NEXT ASSY	USED ON	FINISH	
APPLICATION	DO NOT SCALE DRAWING	ADDRESS:	
		2533 Centennial Blvd. Jeffersonville, IN 47130 Phone: 812-944-7244 Fax: 812-944-7269 E-Mail: mls@mlselectronics.com	
		TITLE: SSHQR-2 SERIES	
		SIZE DWG. NO.	REV
		C	C
		SCALE 8:1	SHEET 1 OF 1

