

APPLICATION

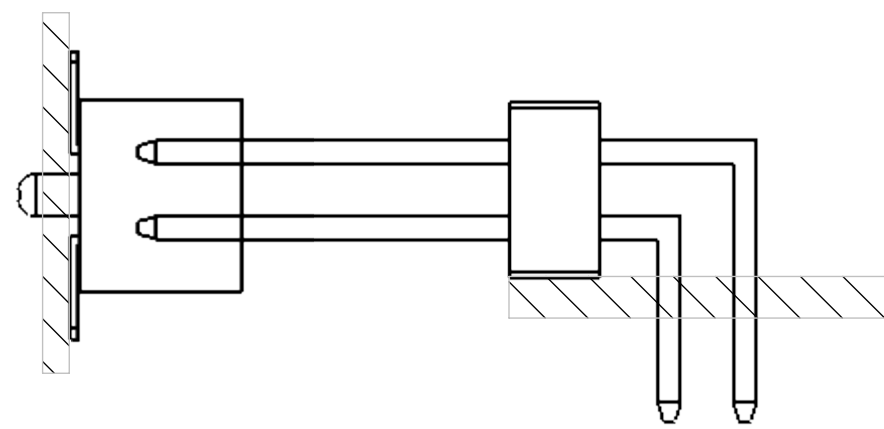

Recommended P.C. Board Layout
SCALE 12:1

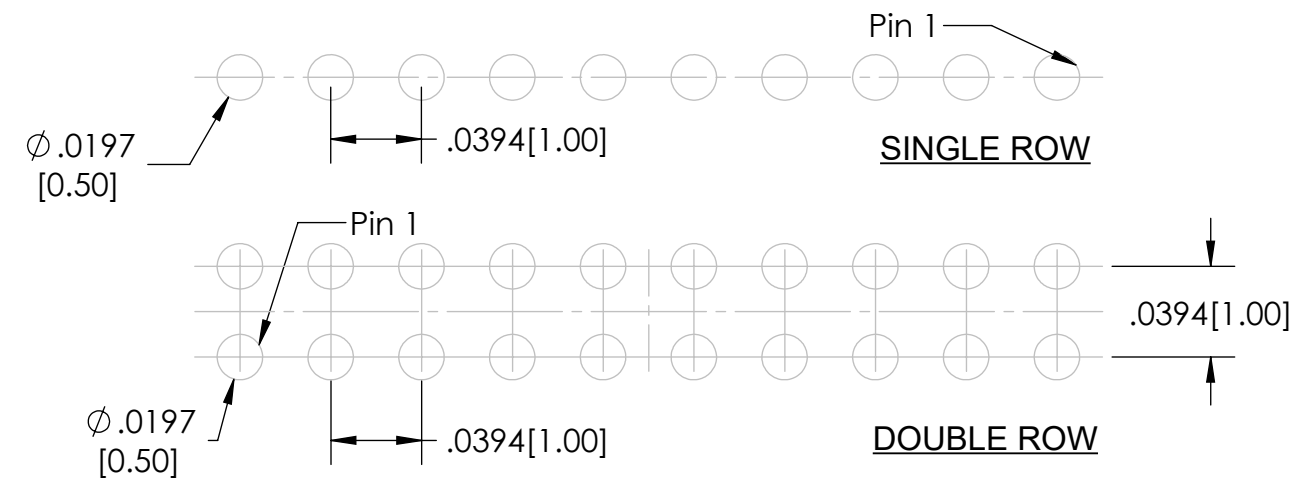

SINGLE ROW

DOUBLE ROW

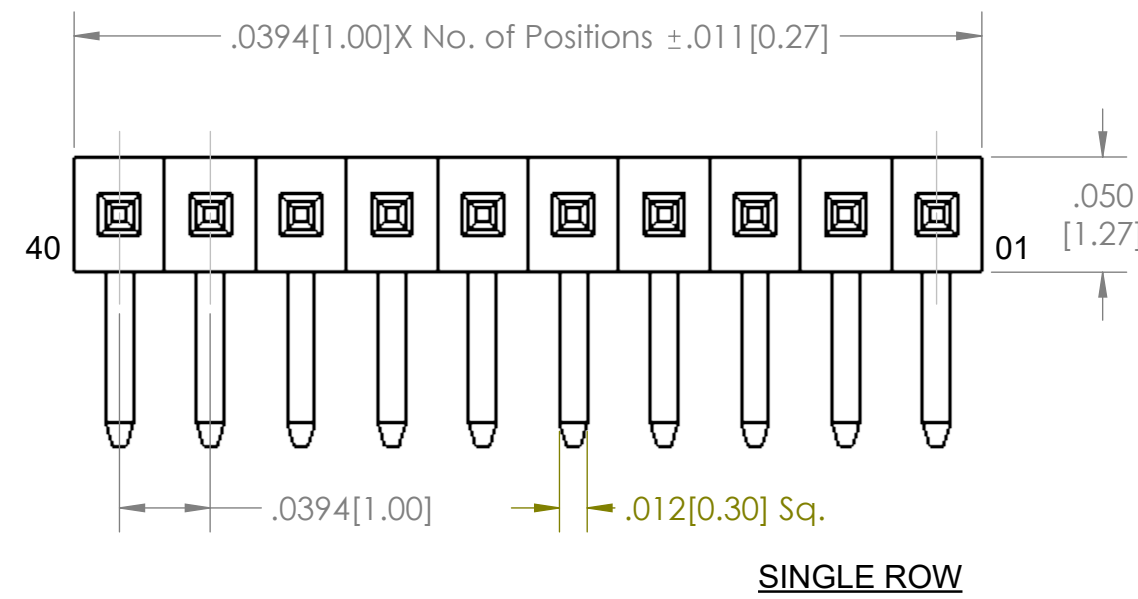
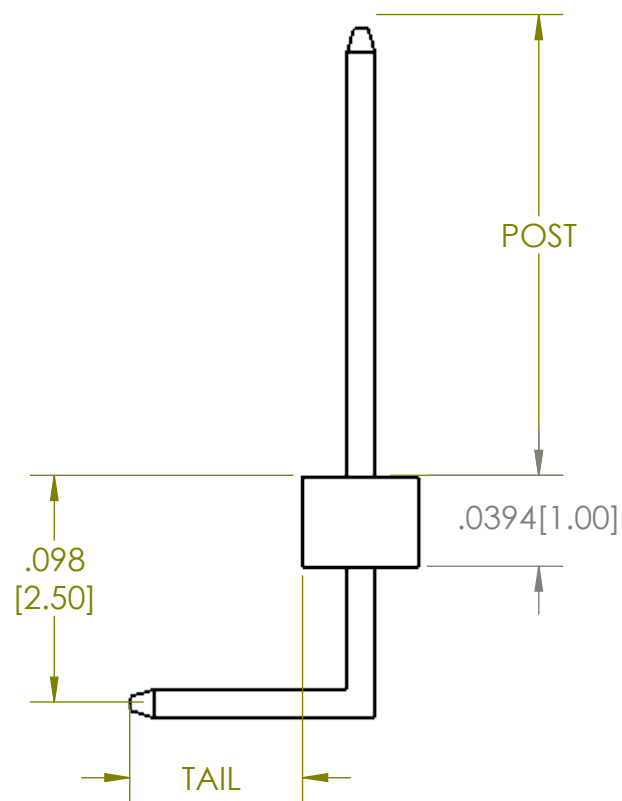
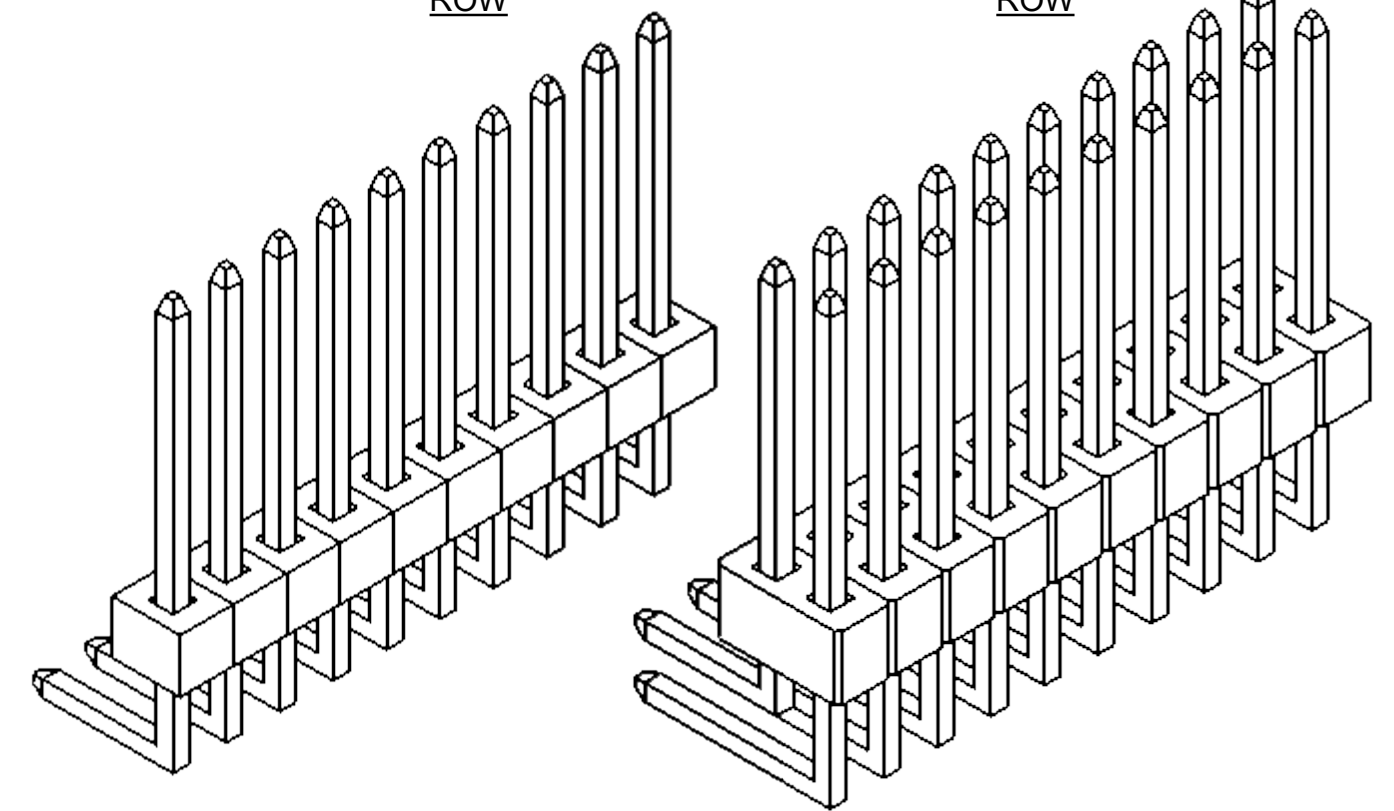

SINGLE ROW

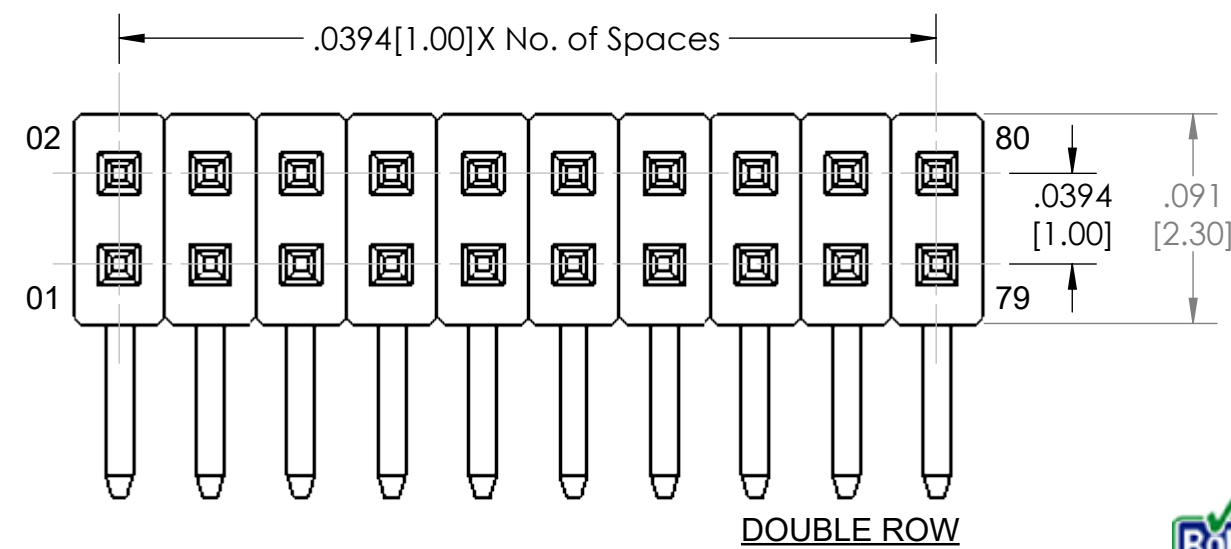
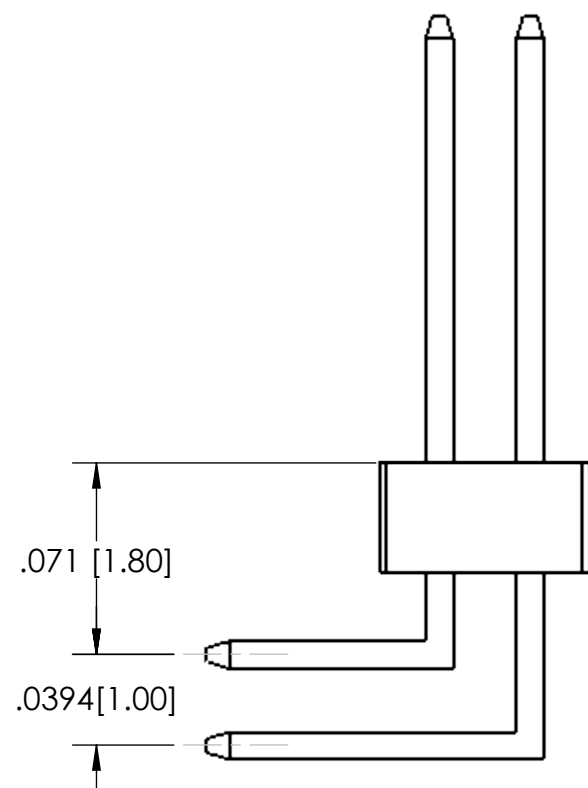

DOUBLE ROW

TSHCR-7 **(A)** - **(B)** - **(C)** - **(D)** - **(E)** - **(F)** - **(G)**

- A. Pins Per Row
 - 1 through 40
- B. Row Specification
 - S= Single Row
 - D= Double Row
- C. Desired Tail Length
 - .040[1.02] - .110[2.79]
 - If left blank, Tail .090[2.31]
- D. Pin Option
 - 02= Overall Length .350[8.89]
- E. Desired Post Height
 - .060[1.52] - .150[3.81]
- F. Plating Options
 - See Plating Options below
- G. Lead Free

Mates with:
LSMSS-7

Plating options	
T	-Matte Tin all Over
F	-Gold Flash over Entire Pin

Specifications:
 Current Rating: 1.0 Ampere
 Insulation Resistance: 1000M Ohms Min.
 Dielectric Withstanding: 300V AC
 Contact Resistance: 20M Ohms Max.
 Operation Temperature: -40°C to +105°C
 Max. Process Temperature
 Wave Solder: Solder Temp 260 ±5°C
 Immersion period: 5 ±5 secs.
 Reflow Solder: Pre-Heat Temp: 100- 150°C for 60 secs max
 Temperature: min. 210°C for 30 secs max.
 Peak Temperature: 260 ±5°C, 10 ±5 secs.
 Manual Solder: 245 ±3°C 3-5 secs.

Materials:
 Contact Material: Phosphor Bronze
 Insulator Material: LCP, UL94V-0
 Tails may be clipped to achieve specific dimensions.
 Products cut to specific sizes are uncancellable/ nonreturnable.
 Parts are subject to change without notice.



PROPRIETARY AND CONFIDENTIAL
 THE INFORMATION CONTAINED IN THIS DRAWING IS THE SOLE PROPERTY OF Major League Electronics. ANY REPRODUCTION IN PART OR AS A WHOLE WITHOUT THE WRITTEN PERMISSION OF Major League Electronics IS PROHIBITED.

UNLESS OTHERWISE SPECIFIED:		NAME	DATE
DIMENSIONS ARE IN INCHES		DRAWN	EOW 10/31/14
TOLERANCES:		CHECKED	GWE 10/31/14
ONE DECIMALS ±.100		ENG APPR.	
TWO DECIMAL ±.010		MFG APPR.	
THREE DECIMAL ±.005		ADDRESS:	
FOUR DECIMAL ±.002		2533 Centennial Blvd.	
NEXT ASSY	USED ON	Jeffersonville, In 47130	
APPLICATION	DO NOT SCALE DRAWING	Phone: 812-670-4174	
		Fax: 812-670-4175	
		E-Mail: mle@mlerlectronics.com	
		TITLE: TSHCR-7 SERIES	
		SIZE DWG. NO.	REV
		C	B
		SCALE 12:1	SHEET 1 OF 1

