

**Recommended P.C. Board Layout**  
SCALE 8:1

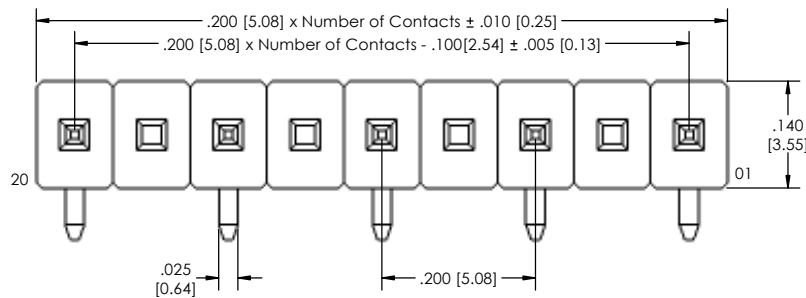

**APPLICATION**

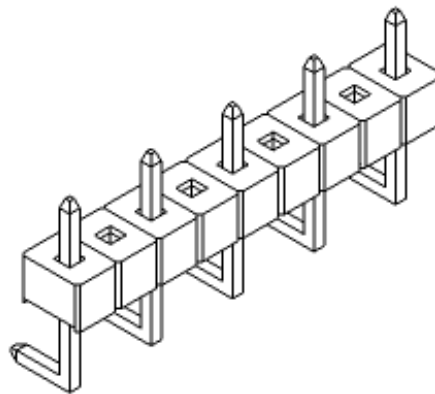
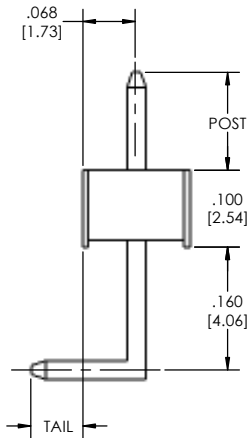
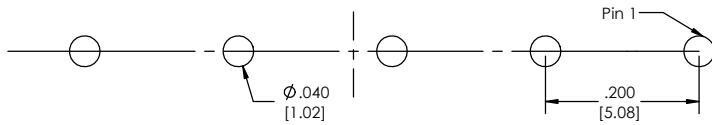
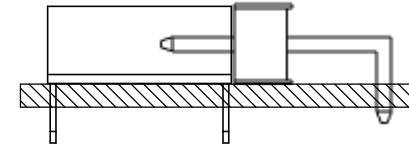

TSHRE-1 **XX** - **X** - **XX** - **X** - **XX** - **XX** - **XXX** - **X** - **LF**  
(A) (B) (C) (D) (E) (F) (G) (H) (I)

- A. Pins Per Row
  - 1 through 20 on .200 [5.08] Centers (20 maximum pins)
- B. Row Specification
  - S= Single Row
- C. Pin Options
  - See Pin Options below
- D. Post Height
  - A= .230[5.84]
  - B= .318[8.08]
- E. Plating Options
  - See Plating Options below
- F. Lock Tight "LT" (Optional)
  - Leave blank if not needed
  - LT= With
- G. Polarized Position
  - Leave blank if not needed
  - If required, specify empty pin position - e.g. 012 for Pin 12
- H. Every Other Pin Filled (.200 Centers)
  - Leave blank if not needed
  - E= Filled
- I. Lead Free

- Mates With:
- BCSS SMBC
  - BSSH SSHQ
  - BSSHC SSHQR
  - BSSQ SSHR
  - BSSQC SSHS
  - BSSQM SSHSM
  - LCSS
  - LSMBC
  - LSWSS

Plating options	
G	-10µ Gold on Contact Area/ Flash on Tail
T	-Matte Tin all Over
GT	-10µ Gold on Contact Area/ Matte Tin on Tail
H	-30µ Gold on Contact Area/ Matte Tin on Tail
F	-Gold Flash over Entire Pin
FT	-Gold Flash on Contact Area/ Matte Tin on Tail

Pin Options		
Tail with .230 Post	Tail with .318 Post	
.090[2.29mm]	N/A[N/A]	16
.190[4.83mm]	.100[2.54mm]	20
.290[7.37mm]	.200[5.08mm]	22
.390[9.91mm]	.300[7.62mm]	24
.490[12.45mm]	.400[10.16mm]	26
.590[14.99mm]	.500[12.70mm]	28
.690[17.53mm]	.600[15.24mm]	30
.790[20.07mm]	.700[17.78mm]	32
.890[22.61mm]	.800[20.32mm]	34
.990[25.15mm]	.900[22.86mm]	36

Specifications:  
 Current Rating: 3.0 Ampere  
 Insulation Resistance: 1000M Ohms Min.  
 Dielectric Withstanding: 600V AC  
 Contact Resistance: 20M Ohms Max.  
 Operation Temperature: -40°C to +105°C  
 Max. Process Temperature  
 Peak: 260°C up to 20 secs.  
 Process: 230°C up to 60 secs.  
 Wave: 260°C up to 6 secs.  
 Manual Solder: 350°C up to 5 secs.

Materials:  
 Contact Material: Phosphor Bronze  
 Insulator Material: Nylon 6T  
 Plating: Au or Sn over 50µ" (1.27) Ni  
 Tails may be clipped to achieve specific dimensions.

Products cut to specific sizes are uncancellable/ nonreturnable.  
 Parts are subject to change without notice.



**PROPRIETARY AND CONFIDENTIAL**  
 THE INFORMATION CONTAINED IN THIS DRAWING IS THE SOLE PROPERTY OF Major League Electronics. ANY REPRODUCTION IN PART OR AS A WHOLE WITHOUT THE WRITTEN PERMISSION OF Major League Electronics IS PROHIBITED.

UNLESS OTHERWISE SPECIFIED:		NAME	DATE	
DRAWN	EOW	01/09/14		
CHECKED	GWE	01/09/14		
ENG APPR.				
MFG APPR.				
DIMENSIONS ARE IN INCHES		ADDRESS:		TITLE: TSHRE-1 Series
TOLERANCES ARE:		2533 Centennial Blvd.		SIZE DWG. NO.
ONE DECIMALS ±.100		Jeffersonville, IN 47130		REV
TWO DECIMAL ±.010		Phone: 812-670-4174		C
THREE DECIMAL ±.005		Fax: 812-670-4175		
FOUR DECIMAL ±.002		E-Mail: <a href="mailto:mle@mlelectronics.com">mle@mlelectronics.com</a>		
NEXT ASSY	USED ON	FINISH		SCALE: 8:1
APPLICATION	DO NOT SCALE DRAWING			SHEET 1 OF 1