

Recommended P.C. Board Layout
SCALE 8:1

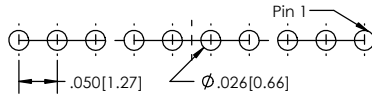

SINGLE ROW

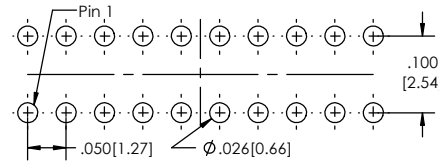

DOUBLE ROW

SINGLE ROW

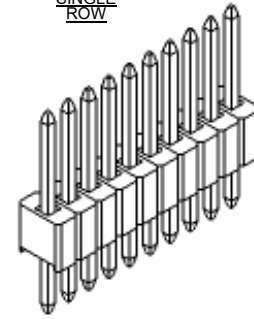

DOUBLE ROW

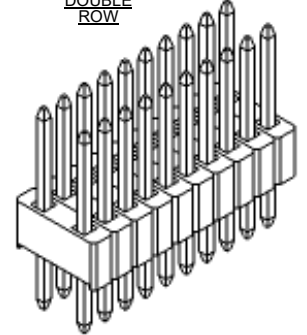

APPLICATION

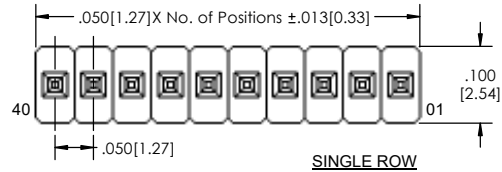
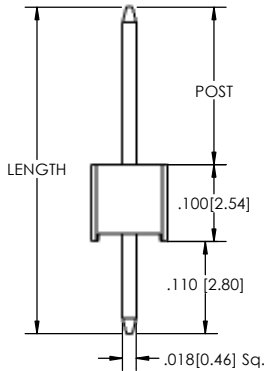
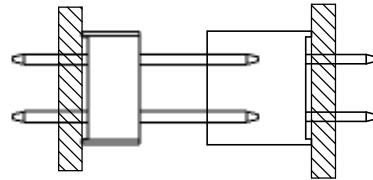

SINGLE ROW

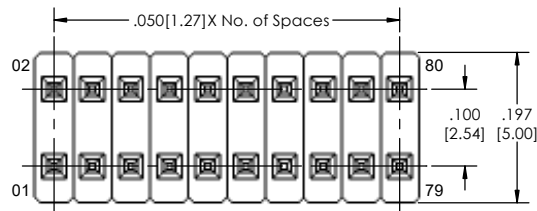

DOUBLE ROW

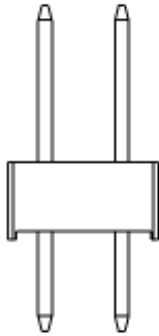

TSHS-6 **XX** - **X** - **XX** - **A** - **XX** - **XXX** - **LF**
(A) (B) (C) (D) (E) (F) (G)

- A. Pins Per Row
- 1 through 40
- B. Row Specification
- S= Single Row
- D= Double Row
- C. Pin Options
- See Pin Options below
- D. A= Tail Length: .110 [2.80]
- E. Plating Options
- See Plating Options below
- F. Polarized Position
- Leave blank if not needed
- If required, specify empty pin position
- e.g. 012 for Pin 12
- G. Lead Free

Mates with:
LSSHS
SMSS
SSHS

Plating options	
G	-10µ Gold on Contact Area/ Flash on Tail
T	-Matte Tin all Over
GT	-10µ Gold on Contact Area/ Matte Tin on Tail
H	-30µ Gold on Contact Area/ Matte Tin on Tail
F	-Gold Flash over Entire Pin
FT	-Gold Flash on Contact Area/ Matte Tin on Tail

Pin Options		
Length	Post with .120 Tail	
.320[8.13mm]	.100[2.54mm]	04
.330[8.38mm]	.110[2.79mm]	05
.410[10.41mm]	.190[4.83mm]	08
.425[10.80mm]	.205[5.13mm]	11
.450[11.43mm]	.230[5.84mm]	14
.505[12.83mm]	.285[7.24mm]	16
.555[14.10mm]	.335[8.51mm]	20
.610[15.49mm]	.390[9.91mm]	22
.625[15.88mm]	.405[10.29mm]	24
.650[16.51mm]	.430[10.92mm]	26
.705[17.91mm]	.485[12.32mm]	28
.755[19.18mm]	.535[13.59mm]	30
.825[20.96mm]	.605[15.37mm]	32
1.050[26.67mm]	.830[21.08mm]	40

Specifications:
Current Rating: 1.0 Ampere
Insulation Resistance: 1000M Ohms Min.
Dielectric Withstanding: 300V AC
Contact Resistance: 20M Ohms Max.
Operation Temperature: -40°C to +105°C
Max. Process Temperature
Peak: 260°C up to 10 secs.
Process: 230°C up to 60 secs.
Wave: 260°C up to 6 secs.
Manual Solder: 350°C up to 5 secs.

Materials:
Contact Material: Phosphor Bronze
Insulator Material: Nylon 6T
Plating: Au or Sn over 50µ" (1.27) Ni

Tails may be clipped to achieve specific dimensions.
Products cut to specific sizes are uncancellable/ nonreturnable.
Parts are subject to change without notice.



PROPRIETARY AND CONFIDENTIAL
THE INFORMATION CONTAINED IN THIS DRAWING IS THE SOLE PROPERTY OF Major League Electronics. ANY REPRODUCTION IN PART OR AS A WHOLE WITHOUT THE WRITTEN PERMISSION OF Major League Electronics IS PROHIBITED.

UNLESS OTHERWISE SPECIFIED:		NAME		DATE	
DIMENSIONS ARE IN INCHES		DRAWN	EOW	02/15/16	
TOLERANCES: ONE DECIMAL ±.100 TWO DECIMAL ±.100 THREE DECIMAL ±.005 FOUR DECIMAL ±.002		CHECKED	GWE	02/15/16	
NEXT ASSY		USED ON	FINISH		
APPLICATION		DO NOT SCALE DRAWING		INTERPRET GEOMETRIC TOLERANCING PER:	ADDRESS:
				MATERIAL	2533 Centennial Blvd. Jeffersonville, In 47130 Phone: 812-670-4174 Fax: 812-670-4175 E-Mail: mle@mlelectronics.com
				TITLE: TSHS-6 SERIES	SIZE DWG. NO.
				SCALE 8:1	REV B
					SHEET 1 OF 1