

**Recommended P.C. Board Layout**  
SCALE 6:1

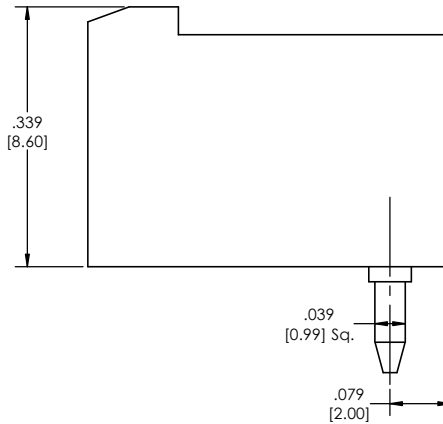
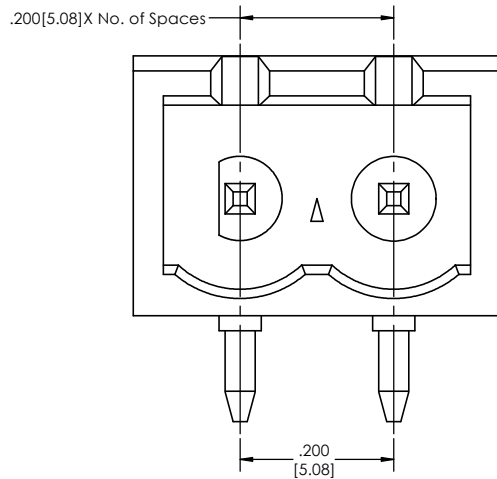
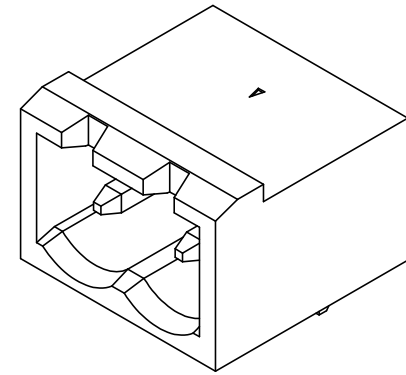
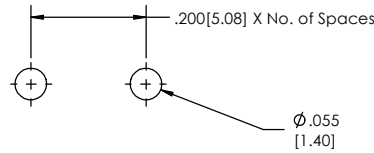

TBPHR - 00 -  -  -  -   
(A) (B) (C) (D)

- A. Pitch**  
- 200= .200(5.08) cl
- B. No. of Positions**  
- 02-24
- C. Color**  
- GR= Green (Standard)  
- BK= Black  
- BL= Blue  
- WH= White  
- GY= Grey  
- OR= Orange  
- YW= Yellow  
- RD= Red  
- BR= Brown
- D. Lead Free**
- Specifications:**  
Current Rating: 10 Ampere  
Voltage Rating: AC 250V  
Insulation Resistance: DC 500V 500M ohms  
Dielectric Withstanding Voltage: AC 2500V/1 minute  
Operation Temperature: -33°C to +105°C

- Materials:**  
1. Body: PA66 (Nylon), UL94 V-0  
2. Terminal: Brass, Tin Plated

Tails may be clipped to achieve specific dimensions.  
Products cut to specific sizes are uncancellable/ nonreturnable.  
Parts are subject to change without notice.



**PROPRIETARY AND CONFIDENTIAL**  
THE INFORMATION CONTAINED IN THIS DRAWING IS THE SOLE PROPERTY OF Major League Electronics. ANY REPRODUCTION IN PART OR AS A WHOLE WITHOUT THE WRITTEN PERMISSION OF Major League Electronics IS PROHIBITED.

UNLESS OTHERWISE SPECIFIED:		NAME		DATE	
DIMENSIONS ARE IN INCHES		DRAWN	EOW	02/10/16	
TOLERANCES:		CHECKED	GWE	02/10/16	
ONE DECIMALS ±.100		ENG APPR.			
TWO DECIMAL ±.010		MFG APPR.			
THREE DECIMAL ±.005		ADDRESS:			
FOUR DECIMAL ±.002		2533 Centennial Blvd. Jeffersonville, IN 47130			
INTERPRET GEOMETRIC TOLERANCING PER:		PHONE: 812-670-4174			
MATERIAL:		FAX: 812-670-4175			
NEXT ASSY USED ON:		E-MAIL: mle@mlelectronics.com			
FINISH:		TITLE: TBPHR-00-200 SERIES		REV	
APPLICATION		SCALE 8:1		A	
DO NOT SCALE DRAWING		SHEET 1 OF 1			

